

# SIOE GARDDWRIAETH LLANARTHNE VILLAGE SHOW



**DYDD SADWRN, AWST 26, 2023  
SATURDAY, AUGUST 26, 2023**

**PRESIDENT OF THE DAY;  
MR. & MRS. GETHIN JAMES, LLANARTHNE,**

**Entries taken between 8.30-10.30am  
Judging to start at 11am promptly  
Show opens at 1pm with Presidents' address  
Horticultural section opens to the public on completion of judging**

**Entry £4.00 adults    children under 16 free**

**NOSON Y SIOE – SHOW NIGHT  
STARTING AT 8PM  
*NOSON Y LLYWYDD - PRESIDENT'S EVENT***

**LOWRI EVANS A'R BAND**

**TOCYNNAU – TICKETS £10 to include food (from hall members)**

Schedule available on [www.neuaddllanarthne.co.uk](http://www.neuaddllanarthne.co.uk)

## BEIRNIAID 2023 JUDGES

**Vegetables**

**Flowers**

**Floral Art**

**Cookery**

**Handicraft**

**Rural Crafts**

**Agricultural Section**

**Children's Section**

**Photography Section**

**Woodwork Section**

**Vintage**

**Dog Show**

**Wine**

**Presidents's Cup will be  
awarded for the best exhibit  
within all classes**

**Mr. Eric Jones, Pencader**

**Mrs. Janet Jones, Pencader**

**Mrs. Helen Jones, Brynhawddgar**

**Mrs. Doreen Martin, Llansawel**

**Mrs Sylvia Thomas, Nantgaredig**

**Mr. Heddwyn Thomas, Dryslwyn**

**Mr. Clive Hodge, Pumsaint**

**Mrs. Caryl Gravelle**

**Mr Gareth Vaughan Jones, Llanarthne**

**Mr Heddwyn Thomas, Dryslwyn**

**Mr. Roger Gale, Swansea**

**Mr. Clive Hodge, Pumsaint**

**Mr. Gordon Lewis, Capel Dewi**

**Kindly donated by the Pencae family**

**Prize money for all adult sections are; 1st;£2.00 2nd; £1.50  
3rd; £1.00**

Competition Rules;

1. Judges Decision will be final
2. All exhibits must be home grown/produced/made with exception to the flowers/foliage used in floral art
3. Points system for perpetual cups are;  
1st - 3pts; 2nd - 2pts; 3rd - 1pt
4. No more than 2 exhibits per person per class
5. Cookery entries must be covered by see through materials
6. No exhibits to be removed before 5pm
7. The committee takes no responsibility for damage or loss that may occur to property or persons

## FANCY DRESS COMPETITION

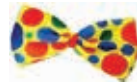

**Classes:**

**3 and under**

**4 – 7 year old**

**8 – 11 year old**

**12 – 16 year old**

**Best Adult**

**Best pair or group**

**Prize money:**

**1<sup>st</sup> £2,**

**2<sup>nd</sup> £1,**

**3<sup>rd</sup> 50p**

**Garden Section**  
**Top Tray - Prize Perpetual Cup for Class 1**

**Vegetable Section**

**Entry 20p**

1. Collection of 6 different vegetables displayed within a 3' space of the table
2. 3 potatoes, coloured
3. 3 potatoes, white
4. 3 parsnips
5. 3 carrots,
6. 2 cabbages
7. 2 leeks
8. 4 pods of peas
9. 4 broad beans
10. 3 onions from sets
11. 3 onions from seeds
12. 3 sticks of rhubarb
13. 4 runner beans
14. 2 lettuce
15. 3 beetroots (globe or long)
16. 4 tomatoes
17. longest runner bean
18. best pair of vegetables not listed above
19. 3 courgettes
20. Heaviest undressed onion

**Floral Section**

**Entry 20p**

class

21. 3 gladioli
22. vase of roses
23. single rose in a vase
24. vase of garden flowers, arranged for effect.
25. best pot plant in bloom max 10" pot
26. best pot plant in foliage max 10" pot
27. pot of cacti or succulent in a bowl
28. 3 pom pom dahlias
29. 5 sweet peas
30. 3 decorative dahlias
31. 3 cactus dahlias

## **Floral Art – all fresh flowers/plant material**

### **Entry 20p**

class

- 32. miniature bouquet 10cms x 10cms
- 33. an arrangement incorporating a kitchen utensil 30cms x 30cms
- 34. An arrangement incorporating twigs or sticks 50cms x 50cms
- 35. An arrangement 'King's Coronation' 50cms x 50cms x 50cms
- 36. A button hole (any gender)

## **Handicrafts**

**All items must be handmade by the exhibitor**

### **Entry 20p**

class

- 37. any quilted item
- 38. a cross stitch item max 18" x 24"
- 39. hand knitted garment
- 39b. a crochet item
- 40. an item made from shells
- 41. invitation card to King Charles' Coronation.
- 42. a decorated bottle
- 43. a cushion cover in any medium.

## **FORWARD FOR 2024 HANDICRAFT SCHEDULE**

door stop, any medium	cross stitch
hand knitted item	something new from something old
any quilted item	hand made poppy
Christmas tree decoration	

## **Photography Section**

**Entered photographs must be taken by the entrant within the last 18 months**

### **Entry fee 20p**

class

- 44. dathliad /celebration [ ar gerdyn/mounted ]
- 45. lliwiau /colours [ ar gerdyn/mounted ][ 2-3 llun / 2-3 photographs ]
- 46. cymuned /community [ar gerdyn/mounted]
- 46a Eisteddfod yr Urdd Sir Gaerfyrddin 2023 / National Urdd Eisteddfod Sir Gaerfyrddin 2023.

## Cookery Section

### Entry 20p

47. loaf of white bread
48. focaccia loaf
49. cherry cake
50. 4 slices of a tray bake
51. set recipe (see below)
52. bara brith,
53. 6 welshcakes (Cup presented in memory of Mrs. Verona Davies, Danyralt)
54. chocolate Sponge Cake (undecorated)
55. a quiche
56. decorated pastry based fruit flan
57. 4 decorated cup cakes on the theme of the 'King's Coronation'
58. any cake baked by a gentleman
59. pot of jam,
60. pot of chutney
61. pot of savoury/sweet jelly
62. pot of fruit curd
63. 4 Eggs

### VEGAN CHOCOLATE AND ORANGE LOAF

#### Ingredients:

- 280 ml soy milk or any non-dairy milk such as almond
- 1 orange zested
- 4 tbsp orange juice
- 150 g dairy free margarine
- 3 tbsp golden syrup
- 1 tsp instant coffee granules
- 275 g self raising flour
- 175 g caster sugar
- 4 tbsp cocoa powder
- 1 tsp bicarbonate of soda

#### Directions:

1. Preheat the oven to 160°C (fan assisted, 180°C non fan) and line a 2lb loaf tin
2. Zest the orange before juicing it. Whisk the orange juice and soy milk together and set aside
3. In a pan over a medium heat, gently melt the margarine, coffee and golden syrup. Once melted take off the heat and allow to cool slightly
4. Sift the flour, cocoa powder, sugar and bicarbonate of soda together in a bowl before adding the milk and margarine mixtures and orange zest. Stir well until the batter is smooth
5. Pour the cake mix into the loaf tin. Bake in the oven for 50 minutes or until a cocktail stick comes out clean when poked into the cake
6. Allow to cool for a few minutes in the tin before turning out onto a wire rack and leaving to cool completely

## Children and Young People's Section

### No entry fee

#### 3 years and under (Nursery and under)

- 68. hand painting A4
- 69. collage of a flower on an A4 piece of paper
- 70. playdough character
- 71. 1 rice Krispie cake in a paper fairy cake case

#### 4 - 7 years (Reception, School year 1 and 2)

- 72. an arrangement of grasses in a jar
- 73. house made of pasta - A4 size
- 74. 3 slices of rocky road
- 75. hand written Party Invitation
- 76. an item out of Lego
- 77. fy anifail anwes/my pet (not mounted)

#### 8 - 11 years of age ( School years 3 – 6)

- 78. design a poster for fireworks night on the 3<sup>th</sup> November 2023 (please keep your designs for Hall use) £3/ person, starting at 6.30pm.
- 79. invitation card to a birthday party.
- 80. 4 decorated cup cakes 'fit for a King'
- 81. gift out of recycled materials max 12" square (30cms square)
- 82. 4 flapjacks
- 83. fy anifail anwes/ my pet (not mounted)

#### School Year 7 – 11

- 84. invitation card to a Halloween party
- 85. flower arrangement in a teacup
- 86. pencil sketch of an animal
- 87. my favourite savoury dish.
- 88. my favourite pudding.
- 89. fy anifail anwes/My pet (not mounted)

### Prize money for children's section

1st - £1.50      2nd - 75p      3rd - 50p

**Winning entry for no. 78 will be used to promote the Fireworks Display in November. Please keep the posters on the wall and we will use them all if we can.**

# Meithrinfa Cwtsh Y Clos Nursery



Mae Meithrinfa Cwtsh y Clos wedi agor yn  
**Llanarthne**, Caerfyrddin. Rydym yn cynnig  
gofal i blant rhwng 6 wythnos a 7 oed.

Come and  
see our  
stand  
today!

Cwtsh y Clos Nursery is in  
**Llanarthney** and provides care for  
children from 6 weeks old to 7 years.

## Ein Nodau – Our Aims

Datblygu o amgylch natur – To develop around nature  
Tyfu mewn amgylchedd heddychlon, gofalggar a chyfeillgar –  
To grow in a peaceful, caring and freindly enviroment  
Dysgu yr iaith Gymraeg – To learn the Welsh language

Cysylltwch/Contact: **Gwenllian Davies**

Danyrallt, Llanarthne, Caerfyrddin, SA32 8JX

01558 678014 / 07896763034 [cwtshyclos@outlook.com](mailto:cwtshyclos@outlook.com)

[www.cwtshyclos.co.uk](http://www.cwtshyclos.co.uk)

*Enillydd Meithrinfa Dydd y Flwyddyn yn 2021*



## **Rural crafts and Agricultural Section**

Entry 20p

### **Classes outside**

- 90. sample of 2023 haylage
- 91. sample of 2023 hay
- 92. longest nettle
- 93. tallest thistle

### **Classes inside**

- 94. something useful made out of baler twine
  - 95. small vintage agricultural hand tool with description of use
  - 96. an item made from re-cycled metal
  - 97. a bird box
  - 98. a wooden item – not turned
  - 99. a thumb stick
  - 100. a turned wooden item
- 

## **Wine Section**

- 101. bottle of red wine
- 102. bottle of white wine
- 103. bottle of cordial
- 104. bottle of any other alcoholic drink



**LLANARTHNE, CAERFYRDDIN  
SA32 8JE**

**(01558) 668989**

**[www.emlynarms.co.uk](http://www.emlynarms.co.uk)**

**[info@emlynarms.co.uk](mailto:info@emlynarms.co.uk)**

**En-suite accommodation, Beer garden Sunday carvery, bar meals..**

**Contact Meleri for further details**



## **Novelty Dog Show**

**STEWARDS:** Mrs. Nerys While and friends

**BEIRNIAD/JUDGE – Mr. Clive Hodge**

Entry Fee: £1.00 per class

### **NOVELTY CLASSES**

1. Any variety handled by a Lady.
2. Any variety handled by a Gentleman.
3. Any variety handled by a child under 15 years of age.
4. Any variety confined to the Parish of Llanarthne.
5. Best conditioned Puppy (6-12 month old)
6. Prettiest bitch.
7. Most handsome dog.
8. Best 6 legs!!
9. Happiest Exhibit
10. Any variety the Judge would like to take home.
11. Any variety not having won a prize **today**.
12. Any variety veteran (7 years and over)
13. Best Trick
14. Best Tit-bit Catcher
15. Best Dog & Owner in Fancy dress!
- 16 Best Novelty Exhibit in Show (All first prize winners from classes 1 - 15 eligible)



**POOP BAGS TO BE USED PLEASE**

# **VINTAGE SECTION**

**Judge: Mr. Roger Gale**

**4 Classes include: Vintage Tractors, Classic Cars, Classic Motor Bikes and Commercial Vehicles.**

**Prize money £10 per Class and Red Rosette**

**Trophy presented to best overall exhibit**

**Meirion Jones**

**Fencing Contractor**

**Bromebyd, Maesybont, Llanelli, SA14 7SY**

**Tel: 01269841029**

**Mob: 07814028160**



**Stock Fence • Post & Rail**

**•All Agricultural, Domestic & Commercial Fencing**

**• Chainsaw Work • Equestrian Fencing**

# **CARMARTHEN ACCIDENT REPAIR CENTRE LTD**

## **BODY REPAIRS AND MOTs**

**Llanstephan Road, Johnstown, Carmarthen SA32 3NG**  
**Telephone: (01267) 223300**

**Gerynant, Capel Dewi, Carmarthen**  
**Telephone: (01367) 290256**

DIOLCH AM EICH CEFNOGAETH  
THANK YOU FOR YOUR CONTINUED SUPPORT



CYNNYRCH  
CONCRID

PENYGROES

CONCRETE  
PRODUCTS

**Our business specializes in the following services -  
Concrete Products, decorative concrete products, concrete  
building products, superior concrete products, standard  
concrete products, concrete block products, concrete paint  
products, precast concrete product, spake concrete  
products, shope concrete products.**

**HEOL NORTON • PENYGROES • LLANELLI**

**SIR GAERFYRDDIN • SA14 7RU**

**Ffôn/Phone: 01269 842278 • Ffacs/Fax: 01269 845026**

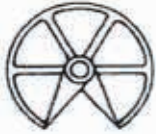

# **Mike Squires Engineering** **Llanarthne**

**Design and Manufacture  
of  
Specialised Equipment  
for handling  
Concrete Beams**



**Tel: 01558 668005**

**Email: [info@squireseng.businessbb.co.uk](mailto:info@squireseng.businessbb.co.uk)**



Proud to support Llanarthne Show

Rydym yn falch I gefnogi Sioe Llanarthne

Beechwood Offices, Talley Rd, Llandeilo, Carmarthenshire, SA19 7HR





Footwear & Footcare

16 King Street, Carmarthen

[www.celticpodiatry.co.uk](http://www.celticpodiatry.co.uk)

01267 237223

- Thickened Fungal & Ingrown Toenails
- Nail Surgery
- Verruca treatment, Corns and callus
- Diabetic Assessment & Advice
- Class V Laser Therapy for any Pain, Inflammation, Arthritis
- Sports Therapy & Osteopathy
- Footbalance Custom Moulded Insoles
- Joya Footwear- Probably the most comfortable footwear ever!



[www.hcpc-uk.org](http://www.hcpc-uk.org)



ROYAL COLLEGE  
of PODIATRY

# T.ALUN JONES & SON

## NEW HOLLAND MAIN DEALER



[www.talunjones.co.uk](http://www.talunjones.co.uk)

Tel: 01558 668383

## Sales - Service - Spares



### McHale



 **NEW HOLLAND**  
AGRICULTURE



**ANTRAILERS**



**Spearhead**



**Quicke**



# **TONY POWELL TRANSPORT LTD**

Haulage contractor  
Hay and Straw Merchant  
Brickwork and Blockwork Delivery  
Waste Carriers  
REG; CM/LM3381NE

**Telephone no: 01269 851349**  
**Mobile: 078360658709**  
**Fax: 01269 851431**

UNIT 7, LLANDEILO ROAD INDUSTRIAL  
ESTATE,  
LLANDYBIE, AMMANFORD  
SA18 3JG

# A&S



## Plant Construction

Land drainage Ltd



**PLANT HIRE | HAULAGE | CIVIL  
CONSTRUCTION | DRAINAGE  
DEMOLITION**

For a friendly, reliable and cost effective  
service please call us

**01558 668 395 / 07793 573 561**

**info@aandsplant.co.uk**

**www.aandsplant.co.uk**

Bro Meusydd, Llanarthne, Carmarthen SA32 8JD



**PROUD TO BE AN INDEPENDENTLY OWNED  
Dedicated Farm Animal Veterinary Practice**

**Yn falch i gefnogi Mudiad Sioe Llanarthne 2023**

**Pleased to be supporting Llanarthne Show 2023**



**Gwasanaeth o ansawdd a phrisiau cystadleuol  
Quality service with competitive prices**

**Carmarthen branch 01267 233266**

**Llangadog branch 01558 821038**

**Offering 24-hour emergency cover, routine fertility work, bull/ram  
fertility testing, dynamic parlour testing, herd/flock health plans, foot-  
trimming, disease investigations and much more!**

***Give us a call today for a friendly discussion or more  
information on our services.***

**[www.prostockvets.com](http://www.prostockvets.com)**



## Pob Llwyddiant i Sioe Gymunedol Llanarthne yn 2023



Gethin James BA (Hons) Arch. MCIAT

### CYNLLUNIAU AR GYFER:

- Adeiladau Newydd, Estyniadau a Gwaith Adnewyddu
- Addasu Ysguboriau, Trosi Lloffttydd
- Adeiladau Hanesyddol a Rhestredig
- Tystysgrifau ar Gyfer Hunan Adeiladu
- Ceisiadau Cynllunio a Rheolaeth Adeiladu
- Goruchwyllo a Rheoli



RICS Cymru Ltd  
with national  
regeneration award  
winner 2013

Ffôn : 01558 668143

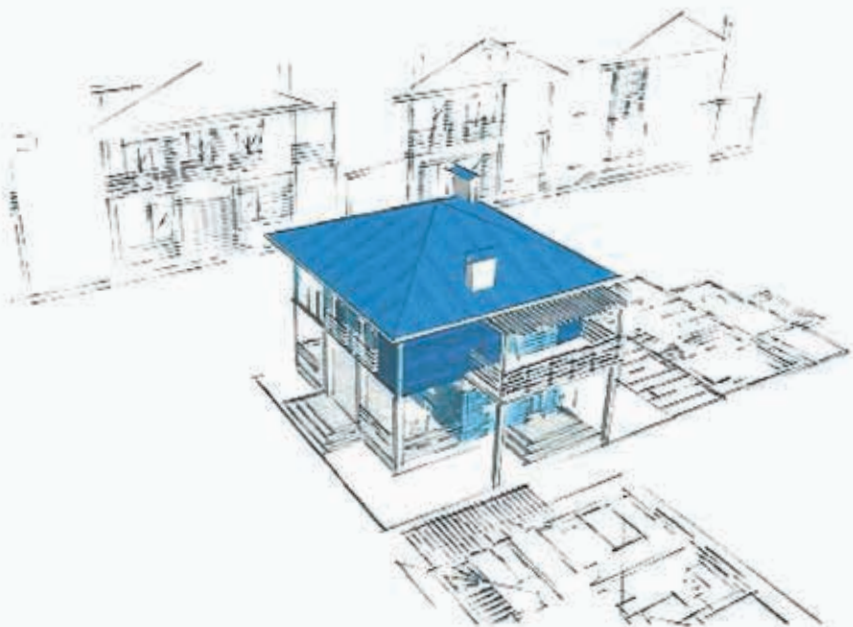

**LAGO Cymru (Cyf)**

Troed y Bryn, Llanarthne, Caerfyrddin, SA32 8JE  
Gwasanaethau Cynllunio Pensaernïol, Rheolwr Prosiectau, ac Arolygwyr Cynllunio  
Architectural Design Services, Project Management & Planning Supervisors  
Ffôn / Tel: 01558 668143 E-bost / Email: gethinjames3@gmail.com



# Pestforce Pest Control Carmarthen

Do you have a pest problem? Rats invading your garden at home? A wasp nest needing to be removed from the side of your office? Pestforce can help!  
Contact Ben and Nick for local, friendly and professional advice and solutions  
Please feel free to get in touch, we are always happy to help

Call us on: **07503280496** or **07565607400**

Email us on: [camarthen@pest-force.co.uk](mailto:camarthen@pest-force.co.uk)



Beehive Removal and Rehome

Bird Proofing, Solar Panel proofing  
and more.



Wasp Removal and  
Treatment

(Picture Queen Wasp and Worker Wasp)



Fleas, Carpet Beetle, Moth, Ants, Spiders, bed Bugs, Moles, Foxes, Rabbits, Squirrels, Mice and Rat, Bird proofing are just some of what we cover please visit our website for more details. [www.pest-force.co.uk/carmarthen/](http://www.pest-force.co.uk/carmarthen/)

# PESTFORCE

PEST & ENVIRONMENTAL CONTROL SERVICES



## Dryslwyn Community Shop & Post office

*Run by the community, for the community, not for profit*

### OPENING TIMES

Mon, Tues, Fri 8.30am to 4.00pm  
Wed, Thurs, Sat 8.30am to 12 noon

- Comprehensive range of everyday food, newspapers, gifts and many other goods
- Post Office services including banking, phone top-ups, foreign currency pick up, Amazon Local Collect, DPD pick up, Royal Mail post and parcels
- Local goods and produce
- Fresh bread and milk - orders taken
- Fairtrade, organic, and healthy options
- Internet Café
- Book exchange

We are always looking for new volunteers. If you would like to help please call in, phone or email the shop. You can be sure of a warm, friendly welcome.

**Tel: 01558 668221**

**Email: [slopdryslwyn@gmail.com](mailto:slopdryslwyn@gmail.com)**



LLAETH  
DYFFRYN  
**Towy**  
VALLEY  
MILK

Mae'r cyfan yn y blas ...  
It's all in the taste ...

Fresh local milk  
in our vending  
machines 24/7



Machines located at:

Llanarthney (SA32 8JD) outside the village hall

Llandeilo (SA19 7HR) outside Iolfa Llandeilo

[www.towyvalleymilk.co.uk](http://www.towyvalleymilk.co.uk)



Olew dros Gymru  
**Oil4Wales**



## **CWMNI DOSBARTHU OLEW CYMREIG, LLEOL, ANNIBYNNOL A THEULUOL GWEITHIO GDYDA'R GYMUNED, I'R GYMUNED**



### **Gwasanaethau Tanwydd ac AdBlue®**

- Olew Gwresogi
- Disel Gwyn
- Disel Coch
- Petrol
- Tanwydd Adnewyddadwy (HVO)
- Ireidiau
- AdBlue® - 10litr, 20 litr, 205 litr, IBC's a fwy

### **Cardiau Tanwydd**

Rydym yn falch o gynnig Cardiau Tanwydd Key Fuels er mwyn i chi allu cael arbed arian ar y teithiau hir. Mae Cardiau Tanwydd Key Fuels yn cynnig rhwydwaith eang o orsafoddd tanwydd gyda dros 2,000 ohonynt wedi'u lleoli ledled Cymru a'r DU.

### **Adran Gofal Boeler**

Mae gennym adran gofal boeleri heb ei hail, sy'n darparu gwasanaeth ar gyfer eich holl anghenion o wasanaethu boeler a gosodiadau cyflawn, i boeleri sydd wedi torri a boeleri newydd. Mae ein holl beirianwyr wedi'u cofrestru a OFTEC.



Aberhonddu/Powys: 01497 238 033  
Blaenau Ffestiniog: 01766 832092  
Caerfyrddin: 01267 275777  
Llantrisant: 01443 800820  
Pwllheli: 01758 650305

AdBlue® : 0800 196 2177  
Aberdaugleddau: 01646 692255  
Gofal Boeler: 0800 433 4353  
Cardiau Tanwydd: 03300 947 585  
Felinfach: 01570 470677



@ sales@oil4wales.co.uk



www.oil4wales.co.uk



@Oil4Wales





# JENKINS REFRIGERATION AND AIR CONDITIONING

## sales & service

Service and Administration Centre at  
Unit 10 & 10 C, Cillefwr Industrial Est, Johnstown,  
Carmarthen, SA31 3RU

T: 01267 237137 or 01267 232532  
Weekend Service Number: 07950 688527  
E: [service@jenkinsrefrigeration.co.uk](mailto:service@jenkinsrefrigeration.co.uk)  
E: [eirian@jenkinsrefrigeration.co.uk](mailto:eirian@jenkinsrefrigeration.co.uk)  
[www.jenkinsrefrigerationcarmarthen.co.uk](http://www.jenkinsrefrigerationcarmarthen.co.uk)



**Panasonic**  
heating & cooling solutions

**arneg**

**Carrier**

**COTSWOLD**  
Dry Equipment Co Ltd

**REFCOM**



# Hafod

FARM SUPPLIES



## PRODUCTS

- EQUINE BEDDING
- SMART HORSE SHAVINGS
- ANIMAL BEDDING
- WHITE BAG DAIRY CATTLE

Meirion - 07779 600112 | Wynne - 07831 461416

[www.hafodfarmsupplies.co.uk](http://www.hafodfarmsupplies.co.uk)

# THE SCRAP LADY

07920131815

**BECAUSE WOMEN**

**ARE JUST USED TO YOUR SCRAP**

**COOKERS, WASHING**

**MACHINES, TUMBLE DRYERS,**

**CARS, CAR PARTS, INFAC**

**ANYTHING METAL**

**COLLECTED AT A TIME**

**TO SUIT YOU**

**MESSAGE ME ON FACEBOOK**



# RR REES RICHARDS

ESTABLISHED 1845

CHARTERED SURVEYORS, LAND & ESTATE AGENTS

  
Professional  
Advice for Towy  
Usk Pylon  
Project

## Adding value since 1845

### Services

Agricultural Tenancies  
Arbitration, Expert Witness & Mediation  
Compulsory Purchase & Compensation  
Estate and Asset Management  
Lease Consultancy  
Property Valuations  
Sales and Auctions

### Sectors

Land & Development  
Leisure Property  
Residential Property  
Retail, Office & Industrial  
Rural Property  
Sustainable Energy  
Utility Infrastructure

Swansea Head Office  
Druslyn House  
De la Beche Street  
Swansea  
SA1 3HH

Tel: 01792 650705

Carmarthen Office  
12 Spilman Street  
Carmarthen  
SA31 1LQ

Tel: 01267 612 021

Tenby Office  
Quay Hill  
Tenby  
SA70 7BX

Tel: 01834 526 126

[property@reesrichards.co.uk](mailto:property@reesrichards.co.uk)  
[reesrichards.co.uk](http://reesrichards.co.uk)

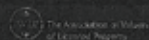



Gwasanaethau Cartref a Cherbyd

**James Bayliss**

Property & Auto Care Services



 James Bayliss Property and Auto Care Services

Contact us for a free no obligation quote:

 07935 290 757  [info@jamesbayliss.cymru](mailto:info@jamesbayliss.cymru) 

# ATEINIADAU YN CYNWYS- ATTRACTIONS INCLUDE

---

**8.30 – 10.30    Entries taken**

**11am                JUDGING STARTS**

**1pm                Show Open – Presidents Opening Ceremony**

**Also including:** Disabled parking  
Meirion Owen and his Quack Pack  
Dressage Display  
Show Jumping Display  
Carmarthen Ukeleles  
Nantgaredig Community Band  
Tipyn o Bopeth Welsh Dancers  
Dog Show  
Vintage Show (4 Classes)  
Tractor run  
Fancy Dress Competition  
Paxton Hounds

**Immediately followed by: PRESENTATION OF CUPS AND  
PRIZES at approx. 4.30pm**

Horticultural Section	Vintage Section
Photography Section	Agricultural Section
Woodwork, Wine etc.,	

## **Local Stallholders include;**

**YFC**

**Llanarthne Church**

**Capel Cefenberach**

**Meithrinfa Cwtsh Y Clos**

**Bouncy Castle**

**Facepainting**

**CRAFTS AND PLANTS GALORE**





# CASTELL HOWELL FOODS LTD



Wales' leading independent food wholesaler

Order Line:  
**01269 846080**



[www.chfoods.co.uk](http://www.chfoods.co.uk)

**ENTRY FORM FOR ALL CLASSES**

**Name:** .....

**Address:** .....

**Phone Number:**.....

Class no.	Details of class	Number of entries (max. 2)

Please remember to collect your prize money after the presentations at the desk in the lobby of the hall after 5pm.

**Uncollected prize money will be donated to Show Funds.  
Diolch am eich cefnogaeth.**

# WHAT'S ON AT LLANARTHNE HALL

Monday:	6.15pm	Zumba and Circl	Melissa 07909 903773
Tuesday	1.30 – 3.30	Craft and Coffee with Linda	
	6.30pm	Yoga	Frances 07412 028384
Wednesday	10am	Home Schooling Group (private)	
	4pm	Theatre Group	Vicky 07725 550402
Thursday	9.30am	Art Classes	Wendy (wpj@hotmail.co.uk)
	1.30pm	Flower Arranging	Susan 07920 263273
	<i>1.30 – 3.30pm MOBILE LIBRARY IN HALL CAR PARK (every 3 weeks)</i>		
Friday	Every 1 <sup>st</sup> and 3 <sup>rd</sup>	Friday Lunch Club	Lydia 12pm – 2pm
	7pm	Young Farmers Club	Iestyn 07772 799298
Saturday	am	Miss Zoe, Tiny Toes Ballet	(see personal webpage)
	am	Community Café 8.30 – 11.30	am(flexible times)
	pm	available for parties	
Sunday	am/pm	available for parties	

**For any bookings, please contact:** Ann Davies 07891 534736 or Emily Peake Pitman on 07898 936602 or email [emily.peake@live.co.uk](mailto:emily.peake@live.co.uk)

## Forthcoming events:

Saturday 9 <sup>th</sup> September	Train Exhibition (organised by Eirwyn Bennett)
Saturday 7 <sup>th</sup> October	Gig Cymreig gyda Baldande
Tuesday 31 <sup>st</sup> October	Children's Halloween Party 6pm – 7pm.
Friday 3 <sup>th</sup> November	Fireworks Night
Friday 1 <sup>st</sup> December	Carols around the tree for Charity
Saturday 2 <sup>nd</sup> December	Breakfast with Santa (am)
Saturday 2 <sup>nd</sup> December	Christmas Fayre (pm) craft tables welcome